

Banquet Hall

7,500 sq.ft.

Bistineau Room
2,500 sq.ft

Cypress Room
2,500 sq.ft

Bodcau Room
2,500 sq.ft

Storage

Storage

Storage

Kitchen

Loading Dock

Main Halls
24,000 sq.ft

A Hall
12,000 sq.ft

B Hall
12,000 sq.ft

First Floor



Lobby

Lobby

Elevators

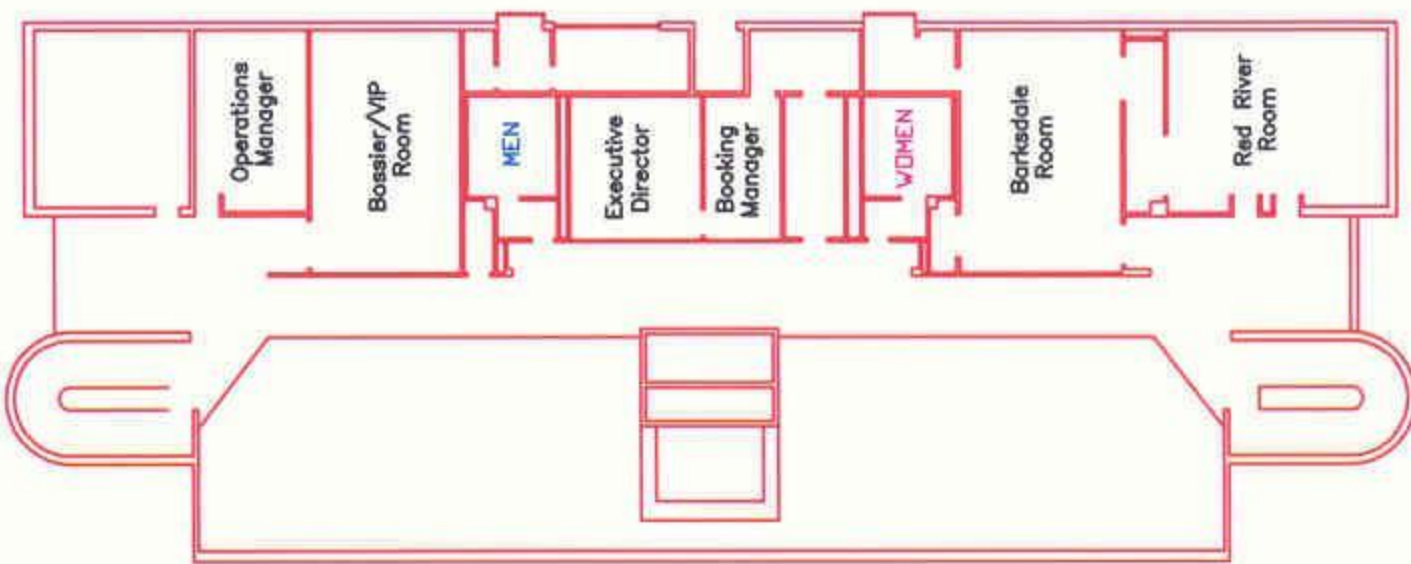

Second Floor